

Figure 5-Rear Frame Assembly

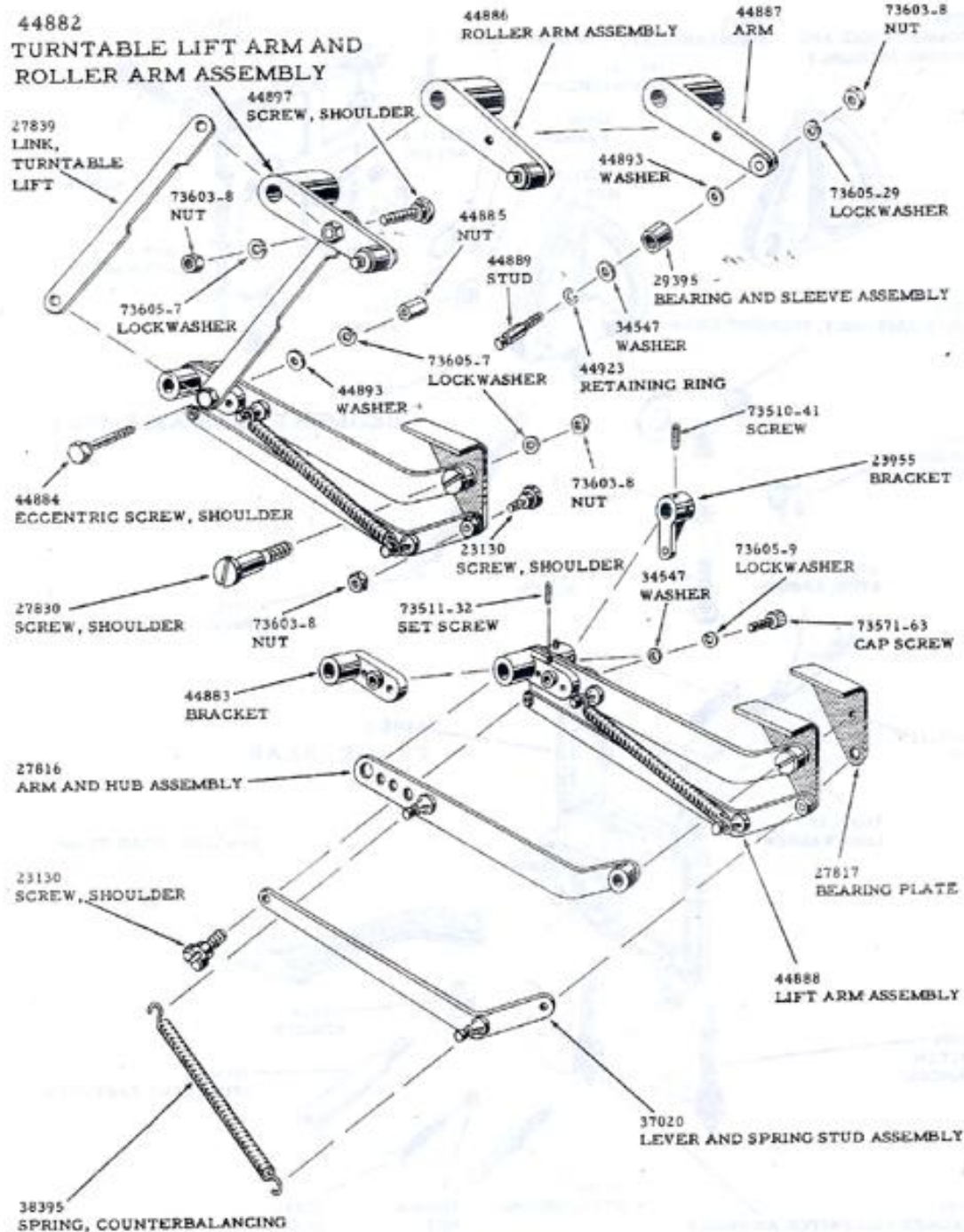

Figure 6-Turntable Lift Arm and Roller Arm Assembly

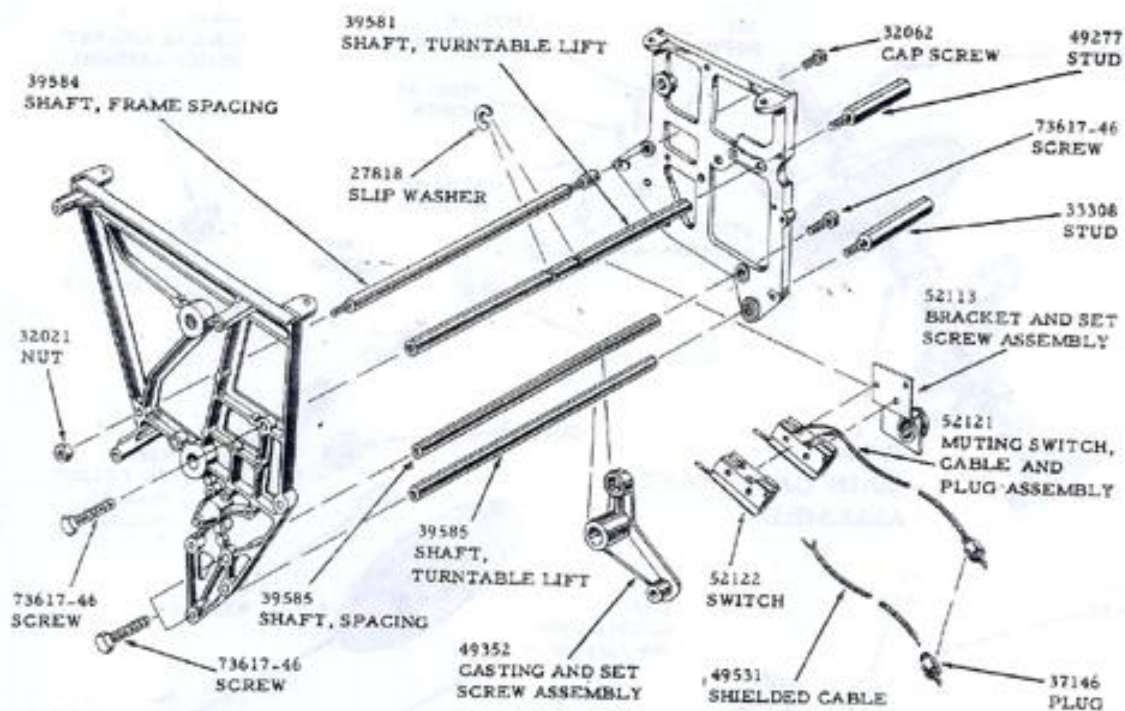

Figure 7. Shafts-Turntable Lift Arm and Roller Arm Assembly

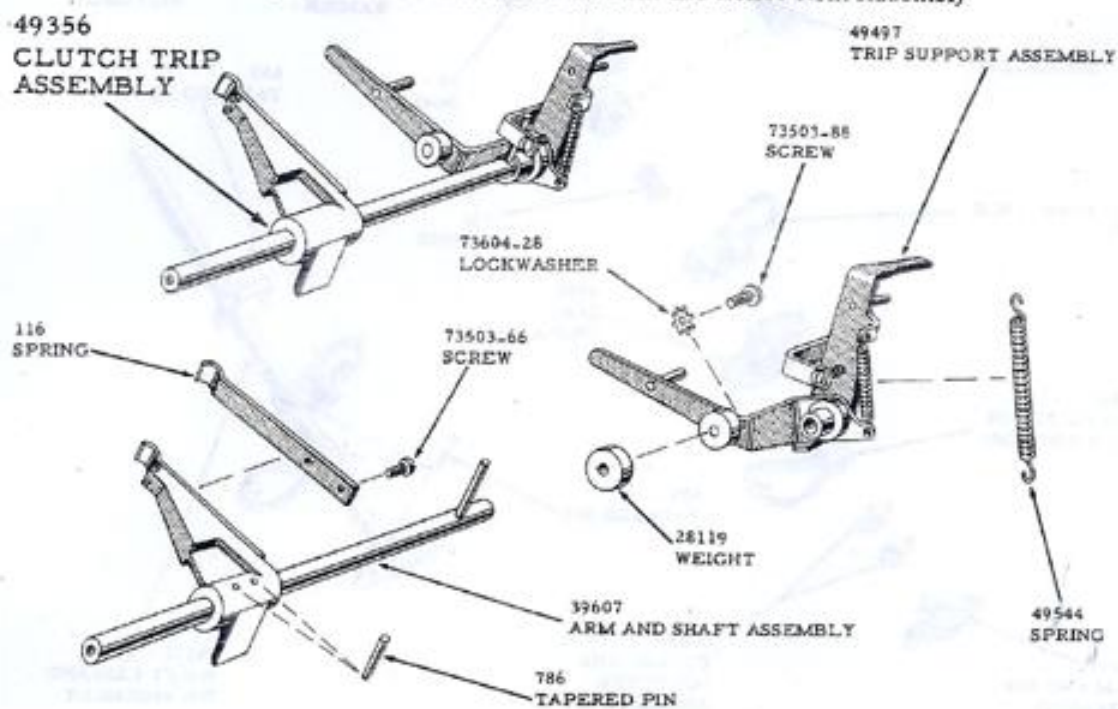

Figure 8. Clutch Trip Assembly

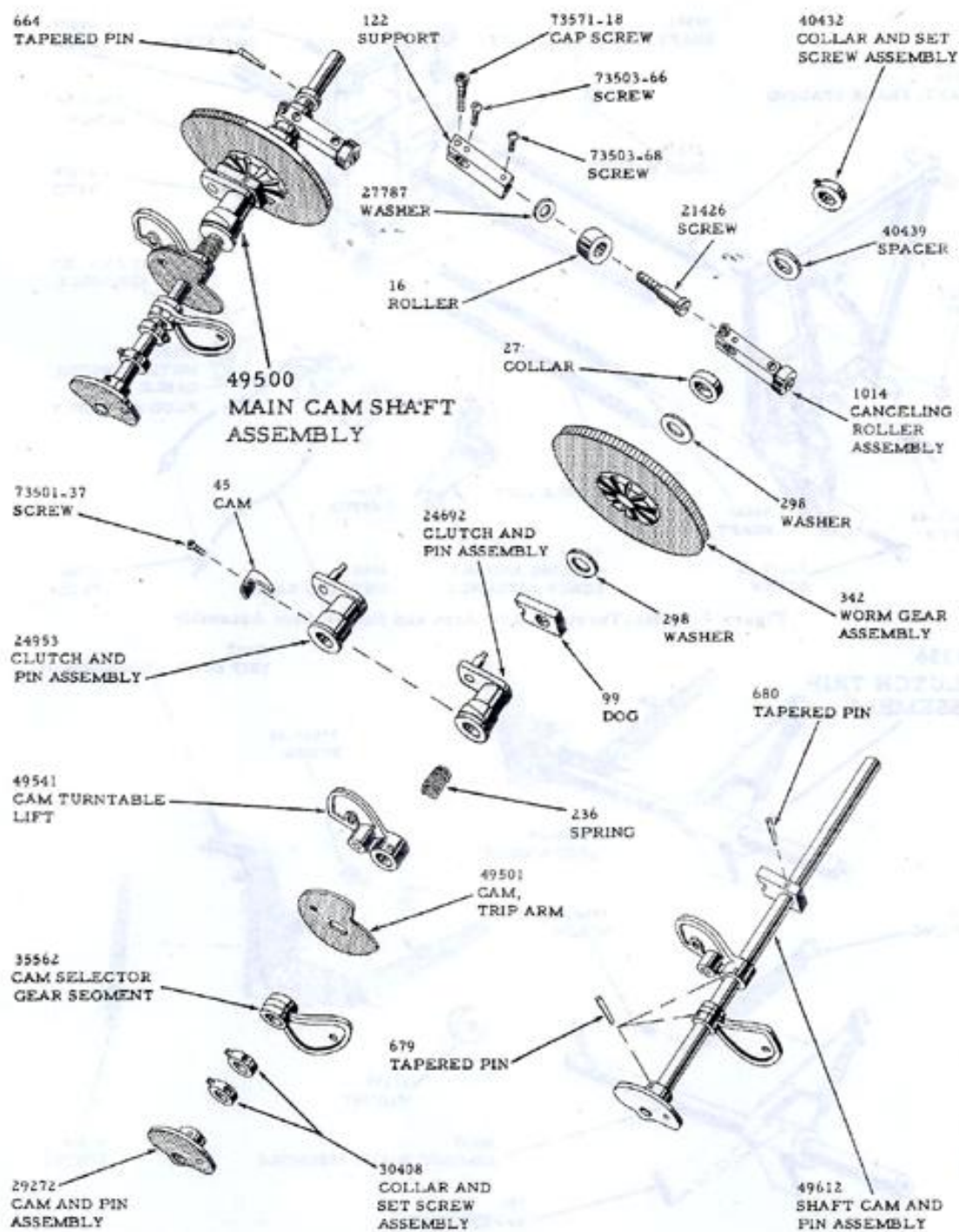

Figure 9-Main Cam Shaft Assembly

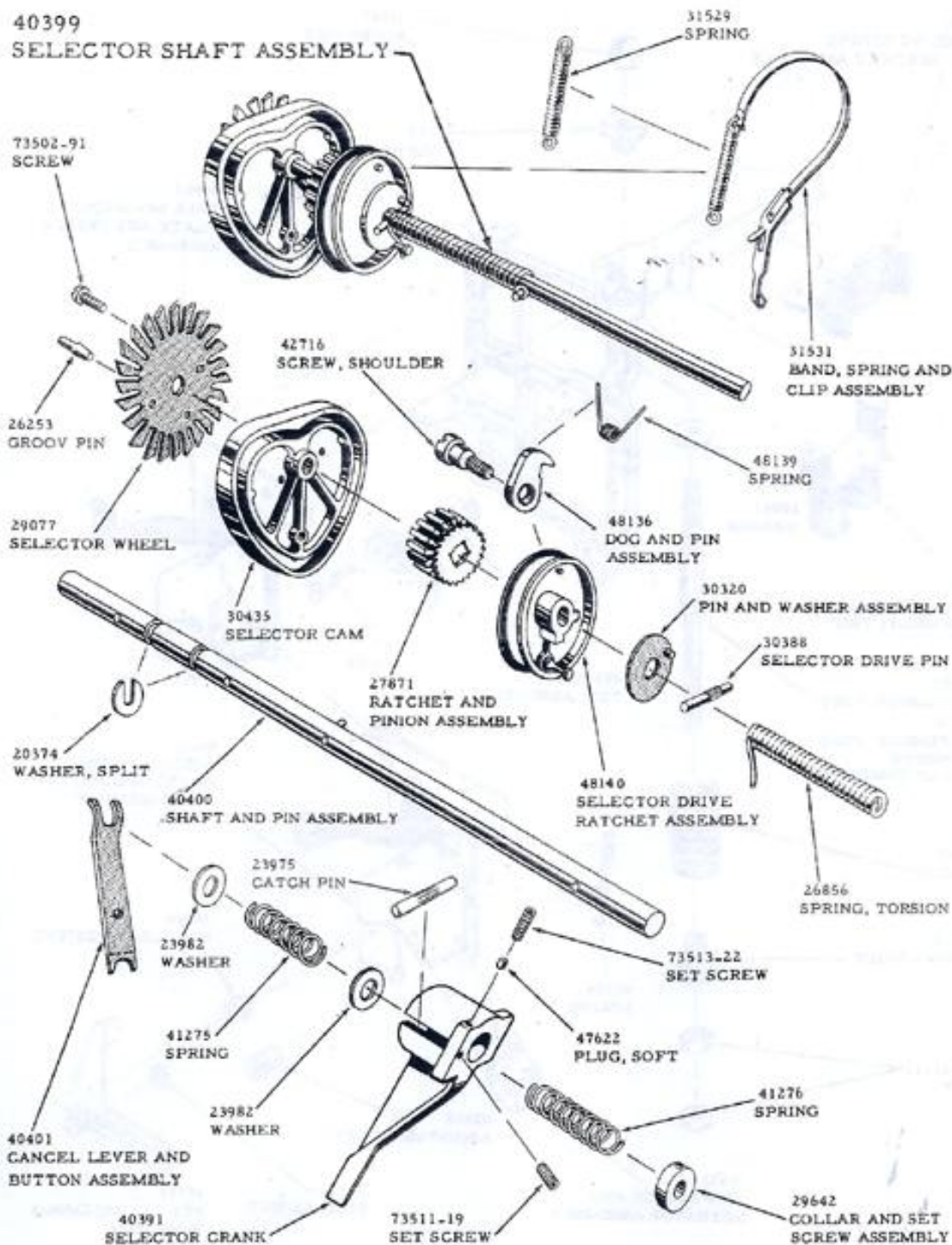

Figure 10-Selector Shaft Assembly

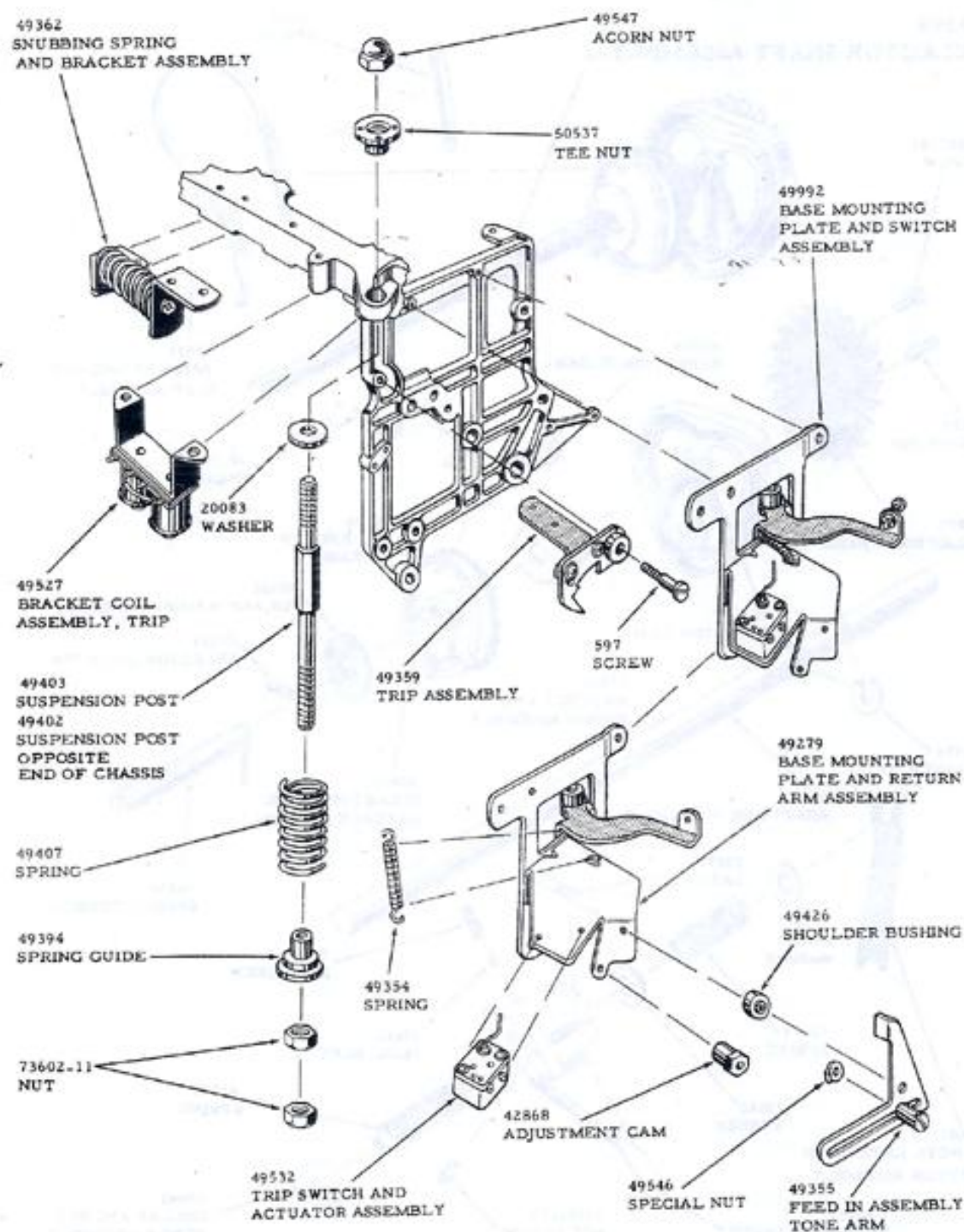

Figure 11-Return Arm, Feed in Lever, Electrical Trip Assembly
and Chassis Spring Mounts

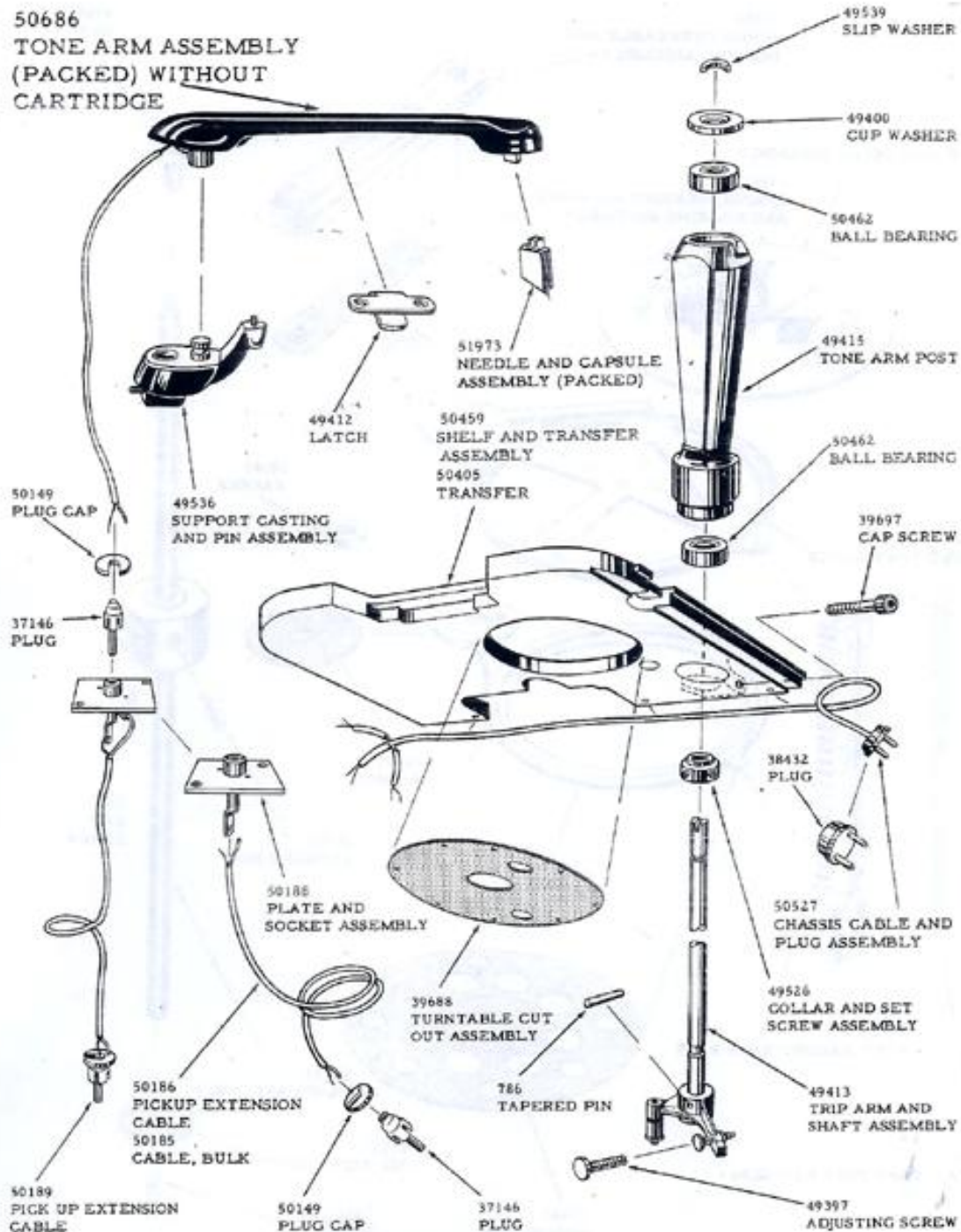

Figure 12-Tone Arm Assembly and Shelf

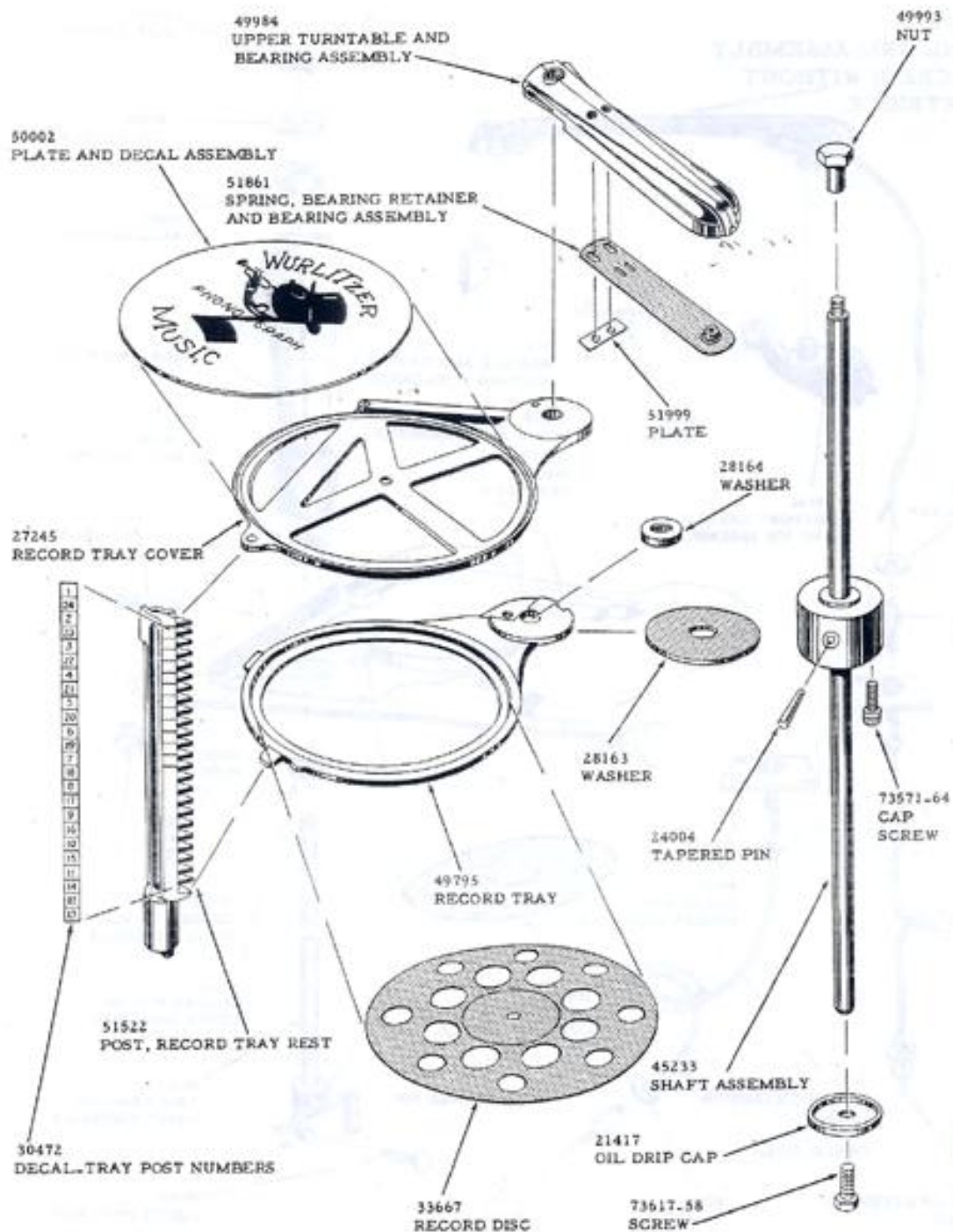

Figure 13-Record Tray Stack, Stabilizer and Selector Rod Assembly
Sheet 1 of 2 Sheets

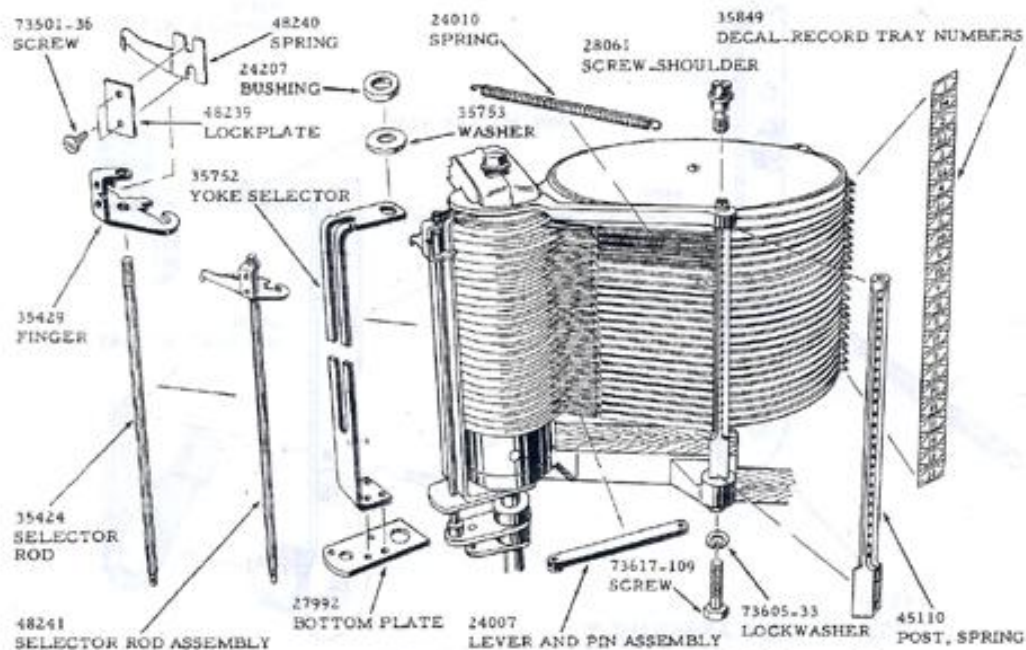

Figure 13-Record Tray Stack, Stabilizer and Selector Rod Assembly
Sheet 2 of 2 Sheets

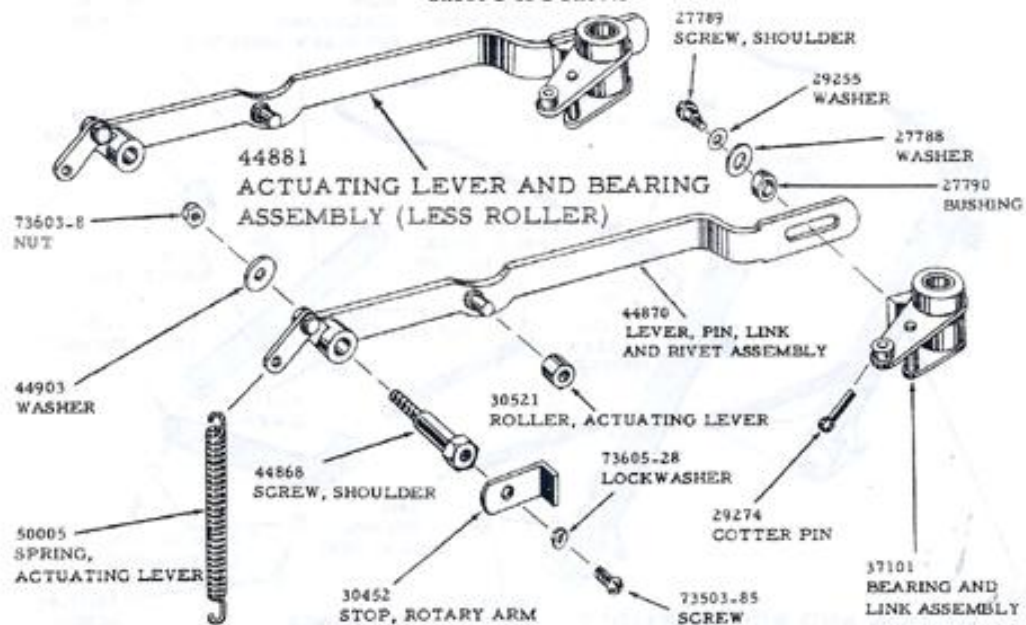

Figure 14-Actuating Lever Assembly

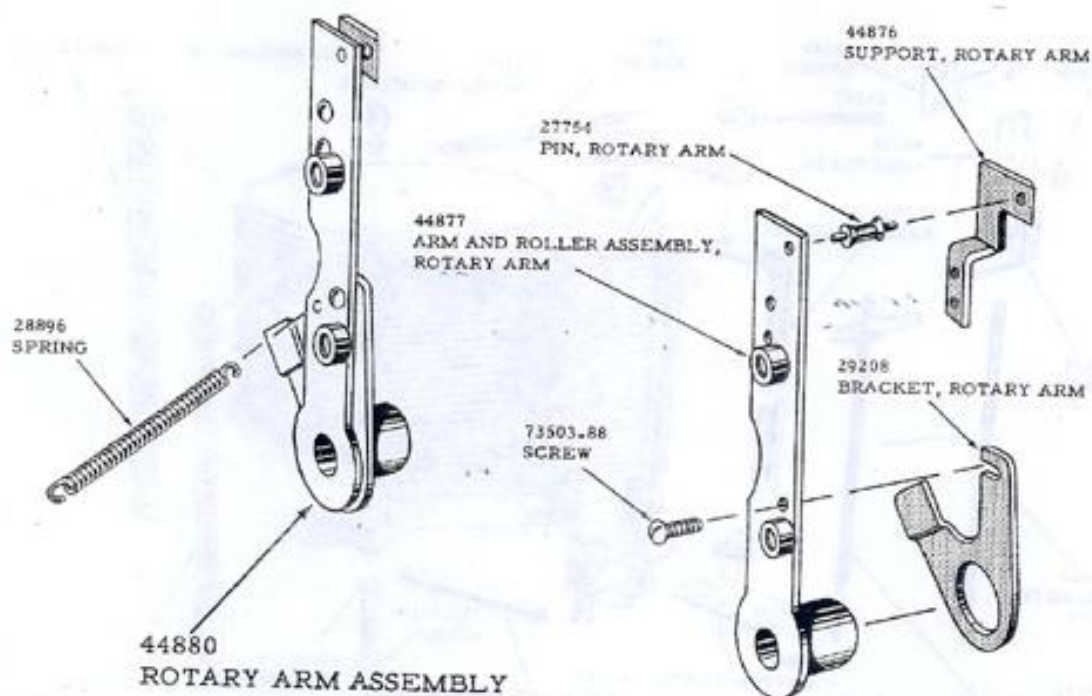

Figure 15-Rotary Arm Assembly

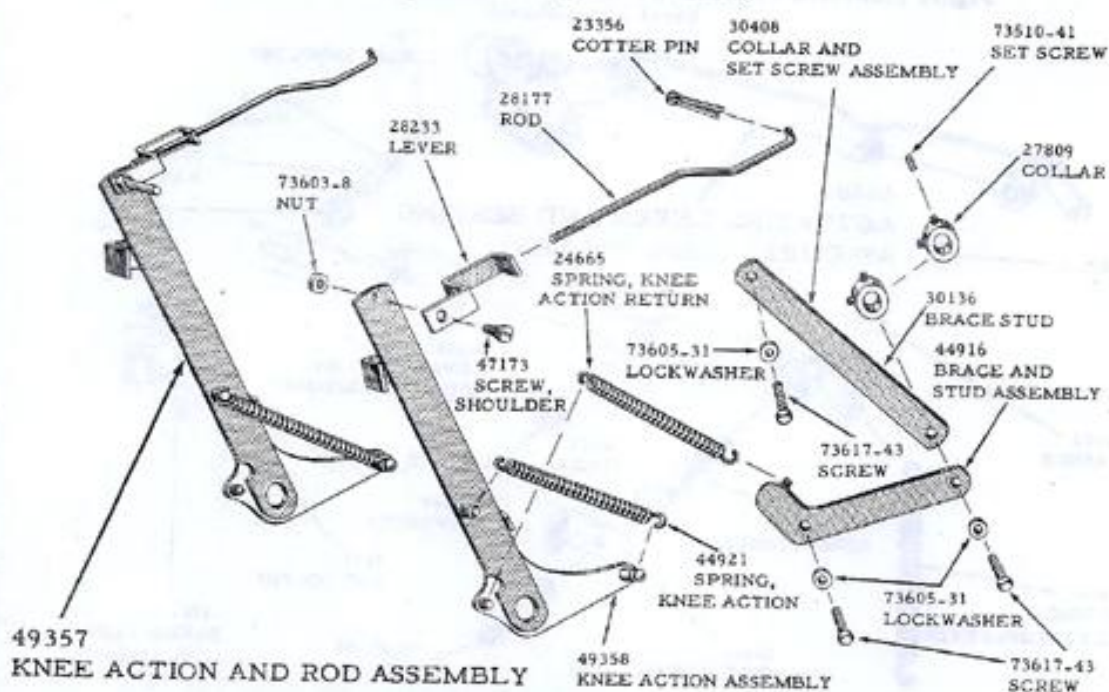

Figure 16-Knee Action and Rod Assembly

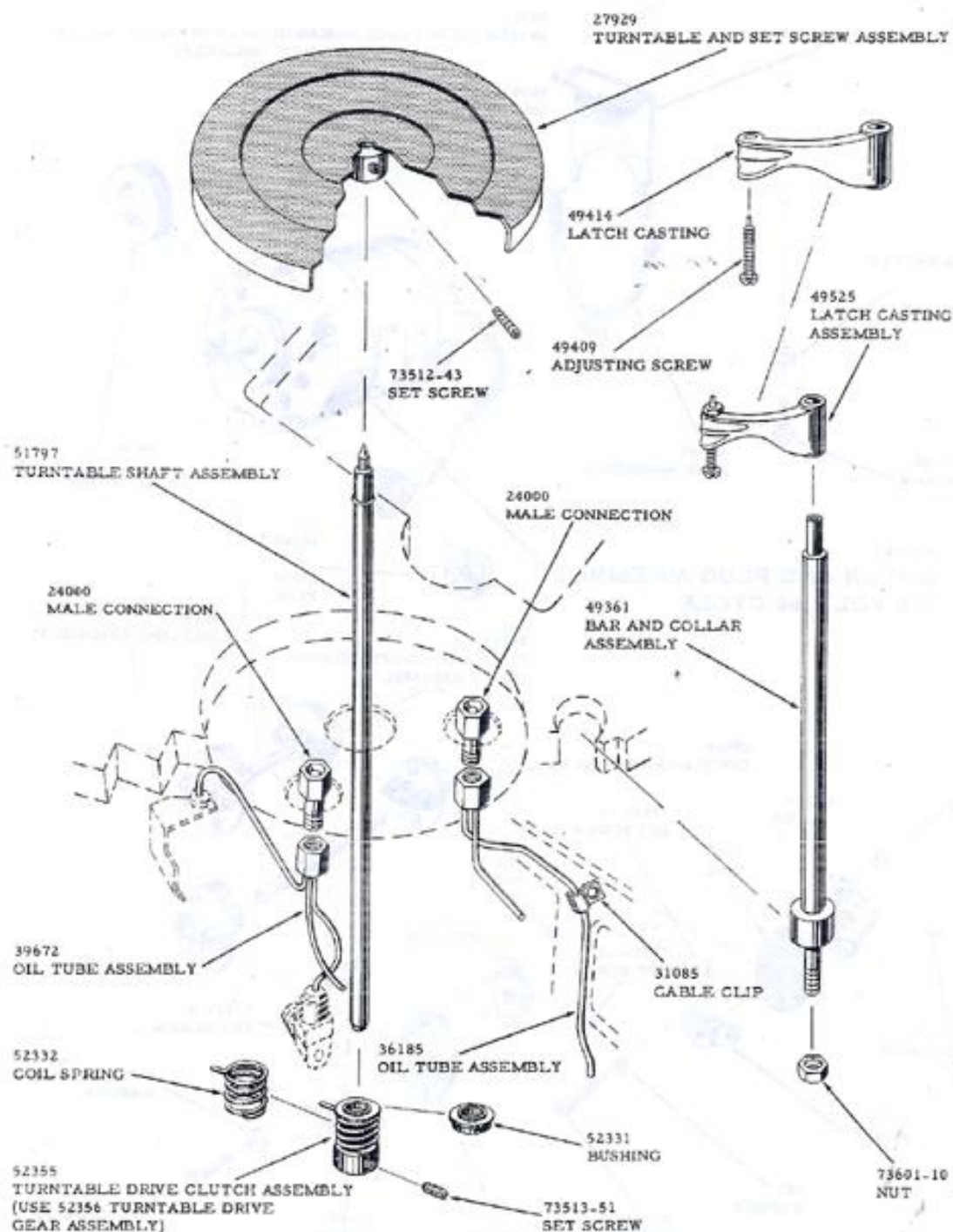

Figure 17-Turntable Shaft, Record Tray Stop Bar and Oil Tube Assembly

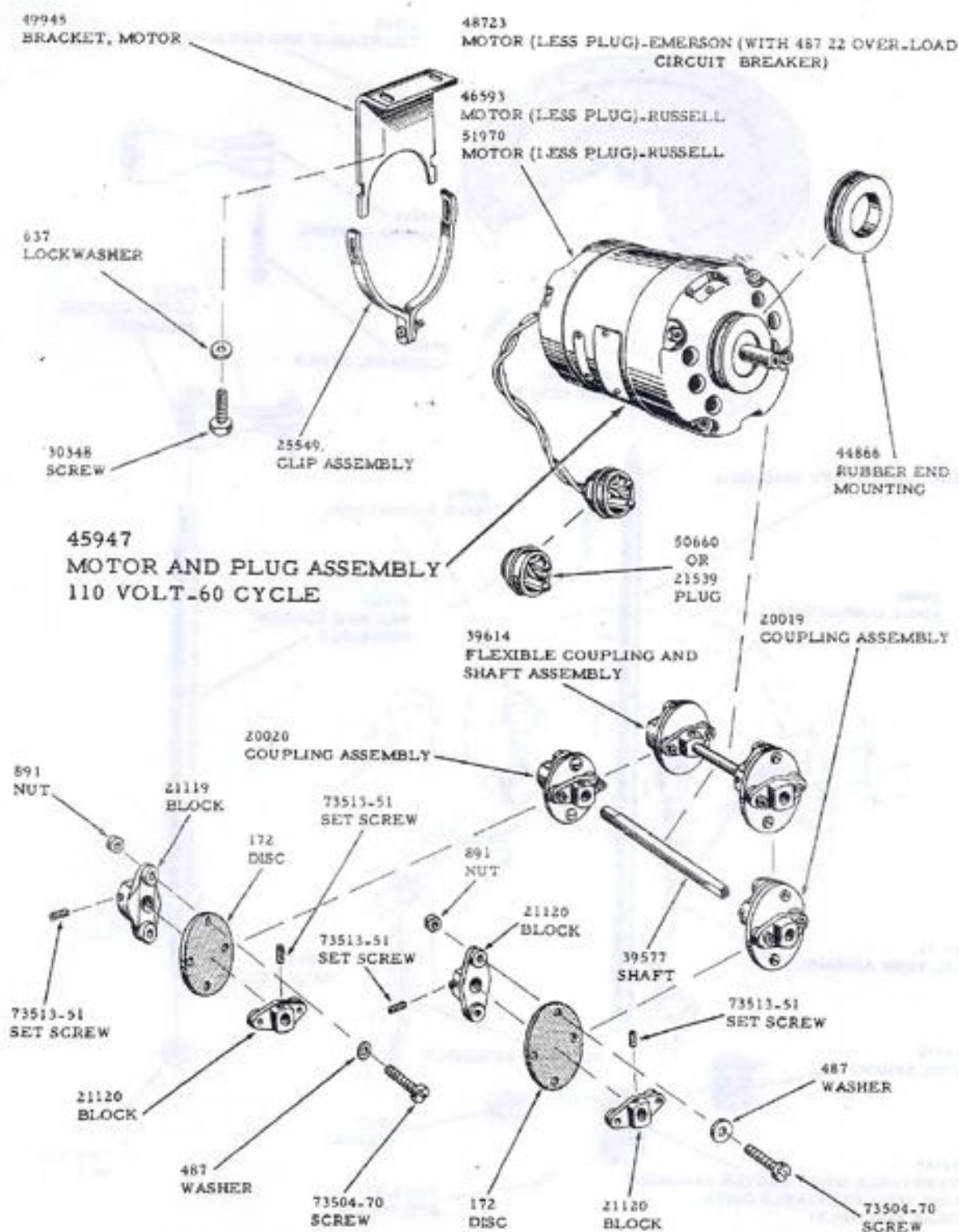

Figure 18.-Motor, Flexible Coupling and Bracket Assembly